

2008 Summer Class Schedule

Come into your own.

Walla Walla
 University

SEVENTH-DAY
ADVENTIST
HIGHER
EDUCATION

For Information

Concerning application information, contact:

Office of Enrollment
(509) 527-2327 or (800) 541-8900/Fax (509) 527-2397
e-mail: info@wallawalla.edu

Concerning academic information, contact:

Clinton A. Valley, Director of the Summer Session
Associate Vice President for Academic Administration
(509) 527-2395 or (866) 441-2395/Fax (509) 527-2394
e-mail: summer@wallawalla.edu

Concerning financial arrangements, contact:

Nancy Cleveland, Assistant Director
Student Financial Services
(509) 527-2815 or (800) 656-2815/Fax (509) 527-2556
e-mail: stufin@wallawalla.edu

Concerning work opportunities, contact:

Twyla Kruger, Employment Coordinator
Student Financial Services
(509) 527-2357 or (800) 656-2357
e-mail: stuemp@wallawalla.edu

Concerning dormitory or off-campus housing, contact:

Dean of Men: Sittner Hall, (509) 527-2111
Dean of Women: Foreman/Conard Hall, (509) 527-2531
Director of Village Student Life: (509) 527-2904

Concerning student life issues, contact:

Ken Rogers, Vice President for Student Life
(509) 527-2511
e-mail: sheila.meharry@wallawalla.edu

Concerning Rosario Beach Marine Laboratory, contact:

James Nestler, RBML Director
Department of Biological Sciences
(509) 527-2602
e-mail: rosario@wallawalla.edu

Concerning School of Nursing, Portland Campus, contact:

Lucille Krull, Dean, or Jan Thurnhofer, Program Adviser
School of Nursing, Portland Campus
(503) 251-6115/Fax (503) 251-6249

Concerning School of Social Work, Montana Campuses, contact:

Nancy Peters, Missoula MSW Program Coordinator
(406) 549-4928 or (888) 296-7416/Fax (406) 549-5215; e-mail: nancy.peters@wallawalla.edu
Paul Cimmino, Billings MSW Program Coordinator
(406) 254-9907 or (888) 263-4880/Fax (406) 254-0648; e-mail: paul.cimmino@wallawalla.edu

Walla Walla University
Summer Session Office
204 South College Avenue
College Place, WA 99324-1198
(509) 527-2395 or (866) 441-2395
summer.wallawalla.edu

Table of Contents

Contact Information	3
Calendar for the Summer of 2008	5
Academic Information	6
Admission	
Registration	
Refund and Withdrawal Deadlines	
Financial Information	8
Tuition and Fees	
Student Employment	
Financial Aid	
Online Education	10
GenEd Online Courses	
Other Online Courses	
Smart Start Program	12
Study Tours	13
Summer Language Institute	13
Rosario Beach Marine Laboratory	14
Short-term Sessions	15
Class Schedule	17
Course Descriptions	22
Administration	24
Schedule Planner	29
Campus Buildings and Map	30

Equal Opportunity Commitment

Walla Walla University maintains a policy of equal educational opportunity for all applicants without regard to gender, race, marital status, color, national and/or ethnic origin, age, physical or sensory disability while administering its educational and admissions policies, financial aid, employment programs, student life and services, or any other university-administered program.

Calendar

Summer of 2008

Main Campus:	
Ten-week Session	June 23–August 29
Eight-week Session	June 23–August 15
Four-week Session	June 23–July 18
Four-week Session	July 21–August 15
Portland Nursing Campus	June 23–August 29
Rosario Beach Marine Laboratory	June 24–August 14
April 21, Monday	Registration Begins
June 5, Thursday	Financial Clearance Begins
June 6, Friday	Smart Start Reservation Deadline
June 23, Monday	Instruction Begins
June 23, Monday (5:00 p.m.)	Orientation (CTC 305)
June 23, Monday	Portland Campus Registration
June 24, Tuesday (6:00 p.m.)	Rosario Beach Marine Laboratory Registration
June 25, Wednesday (11:00 a.m.)	CommUnity (University Church, Heubach Chapel)
June 29, Sunday (9:00 a.m.)	ACT Test, for freshmen who haven't already taken it (TLC classroom)
July 4, Friday	Independence Day Holiday
August 15, Friday	Regular Summer Session Ends
August 29, Friday	Ten-week Session Ends
August 29, Friday	Completion Deadline for August Graduates

Spiritual Programs

Fridays (8:00 p.m.)	Vespers (Conard Courtyard)
Saturdays (9:30 a.m.)	FirstServe (University Church Sanctuary)
Saturdays (10:30 a.m.)	Community Builders/Children and Adults
Saturdays (11:45 a.m.)	Second Worship Service (University Church Sanctuary)
Saturdays (As announced, approx. 20 minutes before sunset)	Meditations (Meets at location of Breakaway activity unless otherwise announced)

Social/Recreational Programs

"Breakaway"

June 25, Wednesday evening	Strawberry & Ice Cream Social
June 28, Saturday night	Softball & Sundaes
July 4, Friday afternoon	Recreation & Fireworks in the Park
July 5, Saturday night	Open Gym
July 8, Tuesday evening	Bowling
July 11, Friday afternoon	Wakeboarding & Waterskiing
July 17, Thursday evening	Play: <i>Anything Goes</i>
July 19, Sabbath	Jubilee Lake Outing
July 23, Wednesday evening	Frisbee Golf
July 26, Saturday evening	Vespers in the Park & Miniature Golf
August 1, Friday afternoon	Wakeboarding & Waterskiing
August 2, Saturday night	Scavenger Hunt
August 5, Tuesday evening	Bowling
August 9, Saturday night	Outdoor Movie
August 12, Tuesday evening	Wakeboarding & Waterskiing

Academic Information

Admission

Main Campus

Individuals seeking admission to the Walla Walla University Summer Session must give evidence of necessary educational background for success in the courses desired and must apply for admission on forms supplied by the Office of Enrollment or online. New students wishing regular admission as undergraduate students must supply the Office of Enrollment with complete official transcripts from high school showing a date of graduation and cumulative grade point average (or satisfactory GED results). New students must also supply the Office of Enrollment with official transcripts of all previous collegiate/university-level work completed, a \$40 application fee, and character reference if requested. A physical examination, tuberculosis skin test, and proof of immunization will also be required.

Undergraduate students must meet the requirements for admission to the freshman class or advanced standing as outlined in the online University Bulletin. Graduate students must meet admission requirements as outlined in the Graduate School Bulletin. North Pacific Union Conference K-12 teachers should apply through their conference educational superintendent.

Mature individuals who apply through the Office of Enrollment but who are ineligible for regular admission or are not working on a degree may register for any course for which they have sufficient background (non-matriculating). Such students are not eligible for a degree; however, by completing requirements for regular admission they may become degree candidates.

Rosario Beach Marine Laboratory

Students planning to enroll at Rosario should submit a Rosario application and fee. See page 14.

Registration

Continuing/returning students may register for classes beginning April 21, either online through OASIS or in person at the Academic Records Office. New students, including Smart Start participants, will be given an opportunity to register at academy campuses or by phone (800-558-2132) after April 21. Financial clearance is also required and may be arranged at Student Financial Services after June 5 (see page 8). Online students may register according to the instructions at wallawalla.edu/academics/distance-learning-d2l (see page 10).

North Pacific Union Conference K-12 teachers who qualify for conference sponsorship may register online at summer.wallawalla.edu after April 21. Conference authorization will be verified before the registration is processed. Early registration is encouraged.

Any students, including K-12 teachers, who have not completed registration in advance may register during regular office hours on the first day of classes. Registration is not official until all procedures have been completed and financial clearance has been arranged. Students who register for classes but do not obtain financial clearance by the second day of their first summer course session will be automatically dropped from all summer courses (see page 7).

Rosario Beach Marine Laboratory

Registration will be held at Rosario on Tuesday, June 24, at 6:00 p.m. Students should arrive on campus June 24. Financial arrangements must be made prior to arrival at Rosario. See page 14.

Late Registration

Students who register after a class or workshop has begun will be charged a late registration fee of \$75. Students may not register for eight-week classes after the first week of the summer term. Students enrolling for short-term courses must be in attendance the first day of classes.

Course Load

The maximum number of credits for which an undergraduate student may enroll is six credits per four-week session unless an overload is approved by the associate vice president for academic administration. A course load of 9-12 credits is considered a full load for undergraduate students for the eight-week session. Course loads for graduate students vary according to the program of study.

Veterans Registration

Undergraduate students receiving veterans educational benefits need to register for a full course load of 9-12 credits. Questions regarding enrollment for summer school should be directed to the veterans adviser in the Academic Records Office.

Withdrawals

Students withdrawing from any or all courses must submit the appropriate official drop voucher to the Academic Records Office before the class(es) are 75 percent over. During Summer Session, withdrawal deadlines vary according to the starting date and duration of each class; the table below lists main session withdrawal deadlines, as well as refund deadlines. A complete schedule of withdrawal deadlines for all sessions is available at the Academic Records Office or online at summer.wallawalla.edu.

Students who register for classes but do not obtain financial clearance by the financial clearance deadline for their **first** summer course session will be automatically dropped from **all** summer courses (see page 6). The financial clearance deadline is the second day of each course session; see table below for main sessions.

When a student withdraws during the quarter, no refund will be made until 30 days after the close of the month in which the student withdrew. Students who leave school without completing withdrawal procedures will be charged until proper arrangements are made.

Course Session Dates	Financial Clearance Deadline	100% Refund Deadline	75% Refund Deadline	50% Refund Deadline	Withdrawal Deadline
June 23 - August 29	June 24	June 27	July 7	July 18	August 6
June 23 - August 15	June 24	June 26	July 2	July 14	August 1
June 23 - July 18	June 24	June 24	June 26	July 2	July 11
July 21 - August 15	July 22	July 22	July 24	July 30	August 8

Financial Information

Tuition

Tuition for the summer quarter is \$547 per quarter hour. All students should plan to pay their tuition at the time of registration. Students who register for classes but do not obtain financial clearance by the second day of their **first** summer course session will be automatically dropped from **all** summer courses.

Fees are charged as published in the online 2007-08 Walla Walla University Financial Bulletin at wallawalla.edu/academics/bulletins. Workshops or extended field trips may require payment of special fees. See page 14 for Rosario Beach Marine Laboratory charges. Students applying to the Portland Campus Nursing program should contact the School of Nursing for financial information.

Tuition – North Pacific Union Conference Teachers

Teachers from within the North Pacific Union Conference of Seventh-day Adventists who are sponsored by their respective employing organizations may present verification of sponsorship in lieu of tuition payment. However, **teachers are expected to pay for books and supplies, graduation fees, any miscellaneous class fees, and room rental charges**. Conference sponsorship does not cover classes requiring individualized instruction (aviation, music lessons, etc).

Tuition Refunds

A student withdrawing from classes during the summer quarter will receive a refund in accordance with the policy in the online Financial Bulletin. A 100 percent refund is given if no more than 10 percent of the class is over, 75 percent if no more than 20 percent of the class is over, and 50 percent if no more than 40 percent of the class is over. Refund deadlines vary according to the length and dates of the class; see page 7 for main session refund dates. A complete schedule of refund dates for all sessions is available at the Academic Records Office or online at summer.wallawalla.edu.

When a student withdraws during the quarter, no refund will be made until 30 days after the close of the month in which the student withdrew. Students who leave school without completing withdrawal procedures will be charged until proper arrangements are made.

Housing

Foreman Hall (women)—\$85 per week double occupancy; \$105 per week single occupancy
Sittner Hall (men)—\$82 per week double occupancy; \$102 per week single occupancy
Hansen Hall (Portland campus)—\$105 per week

Cafeteria

Vegetarian meals are available at the main campus in the Student Association Center (SAC) in Kellogg Hall from 12:00–1:00 weekdays, or as announced. Food items may also be charged at The Express, a university-operated mini-mart. Students should plan approximately \$55-60 per week for food.

Music Fees

Music lessons can be taken for credit or no credit. When lessons are taken for credit, in addition to the regular tuition charge there is a lesson fee of \$240 per quarter for nine half-hour lessons or \$480 per quarter for nine one-hour lessons. When lessons are not taken for credit, the lesson fee is \$276 per quarter for nine half-hour lessons or \$552 per quarter for nine one-hour lessons. Full-time music majors and minors who have taken MUCT 121-123 are not charged the lesson fee. Smart Start students who include music lessons in their 12-hour load are charged the lesson fee unless they are music majors or minors.

Miscellaneous Class Fees

ART 395, Methods of Teaching Art	\$10	INFO 105, Personal Computing	\$80
CHEM 101, Introductory Chemistry	\$20	NRSG 211, Fundamentals of Nursing Lab . . .	\$80
CHEM 102, Introductory Chemistry	\$20	NRSG 212, Health Assess/Nrsg Process Lab .	\$80
EDUC 495, Colloquium: Child Abuse	\$100	NRSG 213, Pharmacology in Nursing Lab . . .	\$80
ENGL 215, Introduction to Film Literature . . .	\$15	PEAC 115, Wakeboarding/Water Activities . .	\$120
ENGL 416, Teaching With Film Literature . . .	\$15		

Insurance

All registered, tuition-paying graduate and undergraduate students attending the College Place, Montana, Portland, or Rosario campuses, and students in the summer work program, are covered by the Student Accident Insurance policy.

If a student has been enrolled in the mandatory student sickness and additional accident insurance during the regular 2007-08 school year, that coverage is in effect through September 1, 2008. All new undergraduate students will be enrolled in this coverage for the summer at a cost of \$348 unless they submit a waiver form verifying comparable coverage to Campus Health and Wellness at registration time.

Employment (On-campus Student Work Program)

Although Walla Walla University strives to meet each student's needs, work opportunities are limited during the summer months. Students are strongly urged to make arrangements for work **before** arriving on campus because employment is not guaranteed. Permission to begin working is given only to students who are registered for summer quarter or who have been accepted for fall quarter. Employment opportunities are available in housekeeping, plant maintenance, The Express, library, campus offices, and academic departments.

Regulations require that all employees hired present **original** documents that establish both their identity and eligibility to work. All students wishing to work on the Walla Walla University campus will be required to present documents **before** they will be authorized to begin work. For more information, contact the Student Employment Center, (509) 527-2357 or (800) 656-2357.

Walla Walla University offers a **SUMMER BONUS** for students who are employed by Walla Walla University, Varsity Contractors, Inc., or Sodexo Food Service. Students who work a minimum of 460 hours at any of these locations during the summer of 2008 **and** who register for at least 12 hours of classes fall quarter 2008 will receive a refund of all dormitory room rent charged for the summer, excluding single room charges, **or** a refund of university housing rent charged for the summer, not to exceed the cost of living in the dormitory. Students participating in this program will be required to sign a Summer Bonus Agreement that authorizes 40 percent of their earnings to be transferred directly to their student account to cover summer room, cafeteria, tuition, and other charges as they occur. If charges exceed 40 percent of their earnings, students are responsible for paying their account promptly when billed.

Financial Aid

Students who need assistance for summer quarter may apply for financial aid. Some Walla Walla University grant dollars may be available; some students may also be eligible for a Federal Pell Grant. Loans may be available, such as Federal Stafford loans and institutional loans through Walla Walla University.

Students who wish to be considered for federal grants and loans will want to submit their 2007-08 FAFSA (Free Application for Federal Student Aid) online at fafsa.ed.gov by **April 15, 2008**. The FAFSA must be received by the federal processor by June 30, 2008. **The federal government will not grant exceptions to this deadline.** A student cannot be considered for the Federal Pell Grant, SEOG grant, Perkins Loan, Nursing Loan, or Stafford Loan if this deadline is missed.

A completed Financial Aid file contains:

1. Correct SAR (Student Aid Report). The SAR is generated by the federal processor after a FAFSA is submitted. Students who list Walla Walla University (code 003799) on their FAFSA will have their SAR electronically sent to Walla Walla University by the federal processor. Students who did not list Walla Walla University on their FAFSA will need to contact Student Financial Services.
2. Walla Walla University Financial Aid Application (FAA). This application may be submitted online at sfs.wallawalla.edu/application.
3. Proof of high school completion (final transcript or letter of verification).
4. Additional documentation, if needed, for verification purposes.

Only financial aid that has been awarded by registration time may be deducted from the estimated costs. Students eligible for Federal or Washington State financial aid must be **registered for classes by June 30**. Students who register or add classes after that date cannot receive Federal or State financial aid for those classes.

Students who are on a waiting list or waiting for a letter of acceptance should complete the financial aid application. Awarding of financial aid does not constitute acceptance into Walla Walla University. However, if a student moves off the waiting list at the last moment, it is to the student's advantage to have the financial aid application already completed.

Online Education

Students taking online courses must have basic computer competency, including use of e-mail and regular Internet access. Information on minimum computer hardware requirements is available at the "Equipment" link on the distance learning website: wallawalla.edu/academics/distance-learning-d2l.

Tuition for all online courses is \$547 per credit hour. Online courses begin on June 23 and end on August 15 unless otherwise indicated. Enrollment minimums and maximums apply.

Online Registration

Students may register for online courses as indicated below:

- Currently enrolled Walla Walla University students register in the usual way through OASIS and arrange financial clearance by June 24.
- Smart Start students register through the Academic Advisement Office, 800-558-2132 or <betty.duncan@wallawalla.edu> and arrange financial clearance by June 24.
- NPUC K-12 teachers register online for all courses, including online courses, at summer.wallawalla.edu.
- Guest students taking courses for transfer to other institutions (not seeking a degree at Walla Walla University) register by completing a registration form and credit card information online at wallawalla.edu/academics/distance-learning-d2l.

For further information, see the "How to Register" link at wallawalla.edu/academics/distance-learning-d2l.

Financial clearance is required for all students. Students who register for classes but do not obtain financial clearance by the second day of their first summer course session will be automatically dropped from all summer courses (see pages 6-7).

GenEd Online Courses

GenEd Online provides general studies courses in an online format. These courses are identified in the class schedule by the letter G. The regular tuition rate applies to GenEd Online courses. Smart Start students will pay the Smart Start rate for these courses.

Students should consult their advisers to determine which courses will satisfy their needed requirements. While all of the following courses are applicable to general studies requirements, the usual minimums and maximums in each area must also be considered. The following courses are offered:

Prefix/Course#	Title	Cr.	Instructor	Instructor's E-mail
Health and Physical Education:				
HLTH 110	Wellness for Living	3	Bob Paulson	< bob.paulson@wallawalla.edu >
History and Social Science:				
ANTH 225	Cultural Anthropology	4	Janet Ockerman	< janet.ockerman@wallawalla.edu >
SOCI 204	General Sociology	4	Cheris Current	< cheris.current@wallawalla.edu >
Humanities:				
ENGL 214	Themes in Lit: Children's Classics	4	Sylvia Nosworthy	< sylvia.nosworthy@wallawalla.edu >
MUHL 124	Introduction to Music	4	Lyn Ritz	< lyn.ritz@wallawalla.edu >
Religion and Theology:				
RELB 466	Galatians & Romans	3	Carl Cosaert	< carl.cosaert@wallawalla.edu >
RELT 202	Christian Beliefs	4	Carl Cosaert	< carl.cosaert@wallawalla.edu >
RELT 417	Inspiration and Revelation	3	Dave Thomas	< dave.thomas@wallawalla.edu >

Other Online Courses

Prefix/Course#	Title	Cr.	Instructor	Instructor's E-mail
Computer Science:				
INFO 105	Personal Computing (Online textbook fee: \$80)	3	Martin Scott	<martin.scott@wallawalla.edu> <i>Course is located at moodle.wallawalla.edu</i>
Education:				
EDAD 526	School Finance	3	Marshall Merklin	<mmerklin@nelsoncrane.org> <i>Instruction on campus: June 23–June 27</i>
EDAD 545	Principalship K-12	4	James Weller	<wellji@Rschoool.org> <i>Instruction on campus: June 23–June 27</i>
EDCI 581	Elementary C & I: Religion	2	Ginger Ketting-Weller	<gkw@wallawalla.edu>
EDUC 381	Elementary C & I: Religion	2	Ginger Ketting-Weller	<gkw@wallawalla.edu>
EDUC 506	Perspectives on School & Community	3	Janet Ockerman	<janet.ockerman@wallawalla.edu>
EDUC 522	Philosophy & Education	3	Wesley Taylor	<wesley.taylor@wallawalla.edu>
EDUC 535	Reading Diagnosis & Remediation	3	Tamara Randolph	<tamara.randolph@wallawalla.edu>
EDUC 551	Action Research	3	Robert Egbert	<robert.egbert@wallawalla.edu>
SPED 535	Reading Diagnosis & Remediation	3	Tamara Randolph	<tamara.randolph@wallawalla.edu>
English:				
ENGL 374	Literature for Children	3	Sylvia Nosworthy	<sylvia.nosworthy@wallawalla.edu>
Social Work and Sociology:				
SOWK 508W1	Social Work & Religion/CP	2	Jim Boyd	<jim.boyd@wallawalla.edu>
SOWK 508W2	Social Work & Religion/Bill	2	Jim Boyd	<jim.boyd@wallawalla.edu>
SOWK 508W3	Social Work & Religion/Miss	2	Jim Boyd	<jim.boyd@wallawalla.edu>
SOWK 548W	Comparative Theories of Social Work Practice <i>Dates: June 23–August 1</i>	3	Heather Vonderfecht	<heather.vonderfecht@wallawalla.edu>
SOWK 549W	Attachment Theory Through the Life Span	3	Nancy Peters	<nancy.peters@wallawalla.edu>
SOWK 563W	Grantsmanship	2	Janet Ockerman	<janet.ockerman@wallawalla.edu>

2008 Smart Start Program

Smart Start is available to any undergraduate student who has never before taken a class at Walla Walla University (except as a high school or academy student). A Smart Start student may take courses online and/or on the College Place campus. A student in this program receives a discounted summer tuition rate. In addition, a full-time Smart Start student who also enrolls for a full load fall quarter will receive a cash rebate of \$500. (The rebate is awarded upon verification of enrollment after the tenth day of fall quarter. The amount of the rebate is prorated for students who completed fewer than 12 summer credits.) Here's what a Smart Start student saves:

Smart Start Tuition Savings

	Per Credit	Full Load (12 credits)
Regular tuition rate	\$547	\$6564
Smart Start tuition rate	\$275	\$3300
Summer tuition savings	\$272	\$3264
Additional savings upon fall enrollment	\$41.67	\$500

Additional Costs

- Deposit (\$25) by June 6
- Dormitory rent (\$82-85 per week; Smart Start students are expected to live in the dormitory if their permanent address is outside the Walla Walla Valley.)
- Meals (approximately \$55-60 per week)
- Textbooks (approximately \$330)
- Health insurance (\$348; waived if proof of other coverage is provided to Campus Health & Wellness)
- Miscellaneous expenses (A few courses have additional fees.)

All tuition is due at registration. Other charges are due when billed. Visa, MasterCard, and Discover are accepted. Some job opportunities are available on campus for students who wish to work (see page 9). A reasonable work load for a summer student taking a full academic load is 8-10 hours per week.

Application Process

Students interested in the Smart Start program should follow the usual application procedure for admission to Walla Walla University and indicate their interest in the summer Smart Start program on the application. (See page 6 for admission information.) After having been accepted to the university, a student may reserve a place in the Smart Start program with a \$25 non-refundable deposit to the Summer Session Office. The reservation and deposit should be mailed or submitted online by June 6, as enrollment is limited. The Summer Session Office will notify the student regarding acceptance into the program.

Smart Start Checklist

In summary, a Smart Start student must:

- ✓ Have earned zero college-level credit at Walla Walla University (except as a full-time academy or high school student).
- ✓ Meet the Walla Walla University admission requirements and be admitted to the university as a regular online or College Place student.
- ✓ Reserve a place in Smart Start with a \$25 non-refundable deposit.
- ✓ Pay the tuition balance at registration, plus other charges when billed.
- ✓ Live in the dormitory while taking courses on the College Place campus, if the student's permanent address is outside the Walla Walla Valley.

Study Tours

The following off-campus courses are available in the summer of 2008. Students interested in tours are encouraged to apply early to the tour director, as enrollments are limited. Financial clearance and registration must be arranged in advance of the tour.

England Study Tour—UK08

Travel dates: June 24–July 15, 2008* Cost: \$4,500 plus airfare
Directors: Dr. Beverly Beem, English Department, and Dr. Gregory Dodds, History Department

*Course dates are June 19–July 25, beginning with online instruction before the tour begins and allowing for completion of coursework afterward. Students will travel to several locations in England and may earn up to eight credits of lower and/or upper division credit in English and/or History. ENGL 200 and ENGL 400 count toward general studies humanities requirement; HIST 200 and HIST 400 count toward general studies history requirement. For further information, contact Dr. Gregory Dodds, e-mail <gregory.dodds@wallawalla.edu>. Students desiring academic credit should register for two of the following courses:

ENGL 200	Topics: English Literature in Context	4	Beem
ENGL 400	Topics: Literature of the English Reformation	4	Beem
HIST 200A	Topics: English History in Context	4	Dodds
HIST 400A	Topics: Reformation	4	Dodds

Shakespeare at Ashland

Dates: August 18–22, 2008 Contact English Department, 509-527-2862 or
Director: Dr. LuAnn Venden, English Department <nancy.cross@wallawalla.edu>, for cost

Students will attend lectures/discussions and performances of four Shakespeare plays at the Oregon Shakespeare Festival. They will do an advance assignment on each play and will turn in a five-page paper within two weeks afterward. Prerequisites: ENGL 234 and ENGL 210, 211, 212, or permission of the instructor. Students must register by June 30 for the following course:

ENGL 360	Shakespeare at Ashland	2	Venden
----------	------------------------	---	--------

Madaba Plains Archaeological Project

Dates: June 25–July 30, 2008 Cost: \$1845 dig fee plus travel plus tuition
Director: Dr. Douglas R. Clark <douglas.clark@wallawalla.edu> of \$100 per credit

The Madaba Plains Project excavations at Tall al-Umayri in Jordan offer academic credit in History and Religion. Students desiring academic credit should register by June 25 for up to 8 credits in the following courses.

HIST 490	Archaeological Fieldwork	0-4	Thomas
RELH 490	Archaeological Fieldwork	0-4	Thomas

Summer Language Institute

Dates: July 13–August 3, 2008 Cost: \$1995 plus airfare
Director: Pat Gustin

The Summer Language Institute (SLI) is a continuing education program offered on the College Place campus for international university students seeking to improve their speaking and listening skills in the United States. It includes 40 hours of in-class English language instruction and 80 hours of field learning enrichment activities. Students stay in local family homes and interact daily with university student guides. A Continuing Education Diploma is awarded to all who complete the program. Academic credit is not offered by Walla Walla University, but a student's home institution may choose to award academic credit for this experience. Further information is available at summer.wallawalla.edu/sli.

Rosario Beach Marine Laboratory

June 24 – August 14

Acceptance

Students planning to enroll at Rosario should submit a Rosario application and fee. Limited facilities at Rosario necessitate restricted enrollments in most classes; consequently, application does not guarantee acceptance. Early submission of application forms and deposit will increase the probability of acceptance. Application forms may be obtained from the Rosario director, c/o Department of Biological Sciences, Walla Walla University, 204 South College Avenue, College Place, WA 99324; (509) 527-2602; <rosario@wallawalla.edu>; or online at rosario.wallawalla.edu.

Tuition

The tuition is \$547 per quarter hour. Students registered for one or two upper-division (400+) courses are charged for 10 quarter hours plus a lab fee of \$1094. Affiliate students pay tuition and lab fees directly to the school in which they are enrolled.

Meals and Housing

All residents of single-student accommodations are charged a flat rate of \$723 for meals for the summer session. Housing charges are as follows:

Single-student accommodations	\$560
Student/family accommodations	\$825

Application Fee

In order to reserve enrollment and housing, a \$40 non-refundable fee is required and due at the time of application.

Insurance

All Rosario students must provide proof of health insurance coverage. Registered, tuition-paying Walla Walla University students are covered by a Student Accident Insurance policy.

Financial Arrangements

Financial arrangements must be made prior to arrival at Rosario. Contact Carolyn Janke, Student Financial Services, Walla Walla University, 204 South College Avenue, College Place, WA 99324, (509) 527-2815 or (800) 656-2815; <stufin@wallawalla.edu>.

Registration and Textbooks

Registration for classes will be held at Rosario on Tuesday, June 24, at 6:00 p.m. Students should arrive on campus June 24. Financial arrangements must be made prior to arrival. Books will be available for purchase at the station. Estimated textbook cost is \$250.

Courses Offered

Upper-division and graduate courses are offered in two blocks. Block A classes meet the first half of each week, and Block B classes meet the last half of each week; thus, students may register for only one course in each block. Students taking General Biology may not register for upper-division or graduate courses.

Block A

BIOL 460	*Marine Ecology (Cowles)
BIOL 417/517	*Behavior of Marine Organisms (Galusha)

Block B

BIOL 426	Systematic Botany (Woodland)
BIOL 440	Human Anatomy (Banks)

Block AB

BIOL 101, 102, 103	General Biology (Fitch)
--------------------	-------------------------

*Marine-oriented course

Short-term Sessions

(For complete information about days and times, consult the Class Schedule on pages 17-21.)

June 16 - June 20

EDUC 474A	Wksp: LEGO Robotics Curriculum Integration (1)	Robinson
EDUC 474B	Wksp: LEGO Robotics Curriculum Integration (2)	Robinson

June 19 - July 25 (Online & England) (Travel dates: June 24-July 15)

ENGL 200	Tpcs: English Literature in Context (4)	Beem
ENGL 400	Tpcs: Literature of the English Reformation (4)	Beem
HIST 200A	Tpcs: English History in Context (4)	Dodds
HIST 400A	Topics: Reformation (4)	Dodds

June 22 - July 3

HIST 200B/400B	Tpcs: U.S. Middle East Policy (3)	Fargo
----------------	-----------------------------------	-------

June 23 - June 27 (plus online instruction until August 15)

EDAD 526	School Finance (3)	Merklin
EDAD 545	Principalship K-12 (4)	Weller

June 23 - July 3 (Portland)

ENGL 539	Wksp: Integrating Reading, Lit, & Writing K-12 (3) (Open to Oregon Conference teachers only)	Cross/Gardner
----------	---	---------------

June 23 - July 9:

FREN 101	Elementary French (4)	Rosas
SPAN 101	Elementary Spanish (4)	Alfaro

June 23 - July 14/15:

SOWK 533	Clinical Issues in Relationships (3) (Mondays)	Vonderfecht
RELH 457	History of Adventism (3)	Maynard-Reid

June 23 - July 17/18:

ECON 211	Principles of Macroeconomics (4)	Thompson
GBUS 263	Business Statistics (4)	Motzev
GBUS 370	Business Communications (4)	Wiggins
CHEM 101	Introductory Chemistry (4)	Cross
EDCI 565/EDUC 365	Instructional Methodology (3)	Rittenbach
EDUC 475	Teaching Reading Skills in the Content Areas (3)	Rittenbach
EDUC/SPED 492	Education of the Gifted (3)	Rittenbach
EDUC 533	Literature-based Reading Instruction (3)	Randolph
EDUC 556	Curriculum Planning (3)	Egbert
PEAC 133	Aerobic Rhythm (1)	Davis
PETH 473	Teaching Elementary Health & Physical Education (3)	Denney
HIST 306	Classical Greece & Rome (4)	Gottschall

June 23/24 - July 24/25:

FINA 101	Personal Finance (2)	Toews
EDUC/PSYC 501	Statistics in Research (3)	Archer
PSYC 521	Psychology of Learning (3)	Archer
NRSG 211	Fundamentals of Nursing (4) (Portland)	Thurnhofer

June 23 - July 28 (Mondays)

PSYC 518	Group Counseling (3)	Stough, L
PSYC 524	Counseling Diverse Populations (3)	Archer

June 23 - July 31/August 1:

EDCI 560/EDUC 360	Elem Curriculum & Instruction: Reading & Language Arts (5)	Randolph
PSYC 130	General Psychology (4)	Egbert
ENGL 416	Teaching With Film Literature (4)	Wiss
SOWK 548W	Comparative Theories of Social Work Practice (3) (Online)	Vonderfecht

June 25 - July 11 BIOL 101	General Biology (4) <i>(Rosario)</i>	Fitch
June 25 - July 30 EDUC/PSYC 502 HIST 490 RELH 490	Statistics Lab (1) Archaeological Fieldwork (0-4) <i>(Madaba Plains, Jordan)</i> Archaeological Fieldwork (0-4) <i>(Madaba Plains, Jordan)</i>	Archer Thomas Thomas
June 29 EDUC 495	Colloquium: Child Abuse (0)	Stough, S
June 30-July 24 PSYC 215 SPED 550	Child & Adolescent Development (4) Understanding Research (3)	Ivy Ivy
July 7 - July 18 ART 395	Methods of Teaching Art (2)	Emmerson
July 7 - July 31 PSYC 506	Advanced Human Development (3)	Melgosa
July 10 - July 29 FREN 102 SPAN 102	Elementary French (4) Elementary Spanish (4)	Rosas Alfaro
July 14 - July 29 BIOL 102	General Biology (4) <i>(Rosario)</i>	Fitch
July 20 - July 25 EDUC 515	Classroom Technology Tools (2)	Ahrens
July 21 - August 11 (Mondays) SOWK 557	Solution-focused Brief Therapy (3)	Zangar
July 21 - August 14/15 CHEM 102 PEAC 133 RELB 438	Introductory Chemistry (4) Aerobic Rhythm (1) Matthew-Mark (3)	Lee Davis Veverka
July 24 - August 14 PEAC 115	Wakeboarding & Water Activities (1)	Windemuth
July 28 - August 1 EDUC 500	Tpcs: Advanced Classroom Technology Tools (2)	Creitz
July 28 - August 29 NRSNG 212	Health Assessment & the Nursing Process (4) <i>(Portland)</i>	Tetz
July 30 - August 14 BIOL 103 FREN 103 SPAN 103	General Biology (4) <i>(Rosario)</i> Elementary French (4) Elementary Spanish (4)	Fitch Rosas Staff
August 4 - August 18 (Mondays) PSYC 522	Counseling Individuals with Addictions (3)	Ivy
August 18 - August 22 (Ashland, Oregon) ENGL 360	Shakespeare at Ashland (2)	Venden

Class Schedule

ART

Call No.	Prefix	Course No.	Course Title	Cr.	Time	Days	Dates	Location	Instructor
1005	ART	184	Intro to Drawing I	2	1:00- 2:50P	MW	6/23-8/13	FAC223	Emmerson
<i>(ART 185, 186, 307, 308, 309 are also available at the above time)</i>							<i>(Additional hour to be arranged)</i>		
1045	ART	251	† Intro to Art	4	10:00-10:50A	MTWRF	6/23-8/15	FAC208	Emmerson
1142	ART	395	✓ Meth of Teaching Art (Fee: \$10)	2	3:00- 4:50P	MTWRF	7/7-7/18	FAC223	Emmerson

BIOLOGICAL SCIENCES

Call No.	Prefix	Course No.	Course Title	Cr.	Time	Days	Dates	Location	Instructor
1300	BIOL	316	Intro to Biol Research II	1-2	Arranged	Arranged	6/23-8/15	Arranged	Staff
1310	BIOL	416	Research in Biology	1-4	Arranged	Arranged	6/23-8/15	Arranged	Staff
1320	BIOL	501	Research in Biology	2-4	Arranged	Arranged	6/23-8/15	Arranged	Staff
1325	BIOL	544	Thesis Proposal	2	Arranged	Arranged	6/23-8/15	Arranged	Staff
1331	BIOL	545	Thesis Research	1-8	Arranged	Arranged	6/23-8/15	Arranged	Staff
1336	BIOL	546	Thesis	2	Arranged	Arranged	6/23-8/15	Arranged	Staff

OFFERED AT ROSARIO BEACH MARINE LABORATORY:

1200	BIOL	101	† General Biology (Limit 24)	4	Block AB	6/25-7/11	Rosario	Fitch
1202	BIOL	102	† General Biology (Limit 24)	4	Block AB	7/14-7/29	Rosario	Fitch
1204	BIOL	103	† General Biology (Limit 24)	4	Block AB	7/30-8/14	Rosario	Fitch
1222	BIOL	417	Behav Marine Organisms (Limit 14)	5	Block A	6/25-8/14	Rosario	Galusha
1225	BIOL	426	Systematic Botany (Limit 14)	5	Block B	6/25-8/14	Rosario	Woodland
1230	BIOL	440	Human Anatomy (Limit 10)	5	Block B	6/25-8/14	Rosario	Banks
1250	BIOL	460	Marine Ecology (Limit 14)	5	Block A	6/25-8/14	Rosario	Cowles
1260	BIOL	517	Behav Marine Organisms (Limit 14)	5	Block A	6/25-8/14	Rosario	Galusha

BUSINESS

Call No.	Prefix	Course No.	Course Title	Cr.	Time	Days	Dates	Location	Instructor
1445	CIS	140	Computer Business Appl	4	12:00-12:50P	MTWRF	6/23-8/15	WEC242	Motzev
1460	ECON	211	† Prin of Macroeconomics	4	9:00-10:50A	MTWRF	6/23-7/18	WEC226	Thompson
1475	FINA	101	Personal Finance	2	6:00- 7:50P	TR	6/24-7/24	WEC226	Toews
1500	GBUS	263	Business Statistics	4	1:00- 2:50P	MTWRF	6/23-7/18	WEC242	Motzev
1525	GBUS	370	Business Communications	4	10:00-11:50A	MTWRF	6/23-7/18	WEC246	Wiggins

CHEMISTRY

Call No.	Prefix	Course No.	Course Title	Cr.	Time	Days	Dates	Location	Instructor
1801	CHEM	101	† Intro Chemistry	4	8:00- 9:50A	MWF	6/23-7/18	RGH182	Cross
			Lab (Fee: \$20)		8:00- 8:50A	TR			
			9:00-11:50A		TR				
1805	CHEM	102	† Intro Chemistry	4	8:00- 9:50A	MWF	7/21-8/15	RGH182	Lee
			Lab (Fee: \$20)		8:00- 8:50A	TR			
			9:00-11:50A		TR				
1881	CHEM	494	Co-op Educ	0-3	Arranged	Arranged	6/23-8/15	Arranged	Lee

COMMUNICATIONS

Call No.	Prefix	Course No.	Course Title	Cr.	Time	Days	Dates	Location	Instructor
2070	COMM	494	Co-op Ed/Prac Ms Media	0-4	Arranged	Arranged	6/23-8/15	Arranged	Staff
2150	SPCH	101	† Fund Speech Comm	4	10:00-10:50A	MTWRF	6/23-8/15	CTC305	Silva

G GenEd Online (general studies) course

† Other general studies course

✓ Course of interest to K-12 teachers

*All summer courses are offered
contingent on adequate enrollment*

COMPUTER SCIENCE

Call No.	Prefix	Course No.	Course Title	Cr.	Time	Days	Dates	Location	Instructor
2340	CPTR	494	Co-op Educ	0-2	Arranged	Arranged	6/23-8/15	Arranged	Aaby
2350	INFO	105	Personal Computing (Fee: \$80) (Limit 10)	3	<u>moodle.wallawalla.edu</u>		6/23-8/15	Online	Scott

EDUCATION AND PSYCHOLOGY

Call No.	Prefix	Course No.	Course Title	Cr.	Time	Days	Dates	Location	Instructor
2500	EDAD	526	School Finance <i>Instruction on campus:</i>	3	Online—see pages 10-11 3:00- 4:50P	MTWRF	6/23-8/15 6/23-6/27	Arranged RGH220	Merklin
2501	EDAD	545	Principalship K-12 <i>Instruction on campus:</i>	4	Online—see pages 10-11 8:00- 9:50A	MTWRF	6/23-8/15 6/23-6/27	Arranged SMH202	Weller
2525	EDAD	565	Practicum in Admin	4	Arranged	Arranged	6/23-8/15	Arranged	Melgosa
2530	EDAD	575	Readings:	2-4	Arranged	Arranged	6/23-8/15	Arranged	Melgosa
2533	EDCI	560	Elem C&I: Rdg/Lang Arts	5	10:00-11:50A	MTWR	6/23-7/31	SMH202	Randolph
2537	EDCI	565	Instructional Methodology	3	10:00-11:50A	MTWR	6/23-7/17	SMH302	Rittenbach
2538	EDCI	567	Instruct Method Practicum	1	7:00- 8:00P	M 6/23+Arr	6/23-8/15	SMH214	Wells
2541	EDCI	581	Elem C&I: Religion	2	Online—see pages 10-11	MTWRF	6/23-8/15	Arranged	Ketting-Weller
2545	EDUC	360	Elem C&I: Rdg/Lang Arts	5	10:00-11:50A	MTWR	6/23-7/31	SMH202	Randolph
2550	EDUC	365	Instructional Methodology	3	10:00-11:50A	MTWR	6/23-7/17	SMH302	Rittenbach
2551	EDUC	367	Instruct Method Practicum	1	7:00- 8:00P	M 6/23+Arr	6/23-8/15	SMH 214	Wells
2589	EDUC	381	Elem C&I: Religion	2	Online—see pages 10-11	MTWRF	6/23-8/15	Arranged	Ketting-Weller
2605	EDUC	474A	Wksp: LEGO Robotics (Limit 16 total, sect A & B)	1	9:00A-12:00 1:00- 4:00P	MTWRF MTWR	6/16-6/20	CSP166	Robinson
2607	EDUC	474B	Wksp: LEGO Robotics	2	9:00A-12:00 1:00- 4:00P	MTWRF MTWR	6/16-6/20	CSP166	Robinson
2611	EDUC	475	Tch Rdg Skls Content Area	3	3:00- 4:50P	MTWR	6/23-7/17	SMH302	Rittenbach
2615	EDUC	492	Education of the Gifted	3	8:00- 9:50A	MTWR	6/23-7/17	SMH302	Rittenbach
2625	EDUC	495	Colloquium: Child Abuse (Fee: \$100)	0	8:00A-12:00 1:00- 5:00P	Sunday	6/29	SMH202	Stough, S
2627	EDUC	500	Tpcs: Adv Cls Tech Tools (Limit 25)	2	1:00- 5:00P	MTWRF	7/28-8/1	RGH050	Creitz
2630	EDUC	501	Statistics in Research	3	5:30- 7:20P	TWR	6/24-7/24	SMH102	Archer
2631	EDUC	502	Statistics Lab	1	7:30- 8:45P	W	6/25-7/30	SMH102	Archer
2635	EDUC	506	Perspec Schl/Community	3	Online—see pages 10-11	MTWRF	6/23-8/15	Arranged	Ockerman
2637	EDUC	515	Clstrm Technology Tools (Limit 25)	2	2:00- 5:00P 7:00-10:00A	Sunday MTWRF	7/20-7/25	RGH050	Ahrens
2640	EDUC	522	Philosophy & Education	3	Online—see pages 10-11	MTWRF	6/23-8/15	Arranged	Taylor
2642	EDUC	533	Lit-based Reading Instruc	3	1:00- 2:50P	MTWR	6/23-7/17	SMH302	Randolph
2645	EDUC	535	Reading Diagnosis/Remed	3	Online—see pages 10-11	MTWRF	6/23-8/15	Arranged	Randolph
2650	EDUC	551	Action Research	3	Online—see pages 10-11	MTWRF	6/23-8/15	Arranged	Egbert
2652	EDUC	556	Curriculum Planning	3	1:00- 2:50P	MTWR	6/23-7/17	SMH202	Egbert
2655	EDUC	571	Action Research Lab	1-4	Arranged	Arranged	6/23-8/15	Arranged	Staff
2660	EDUC	575	Readings:	2-4	Arranged	Arranged	6/23-8/15	Arranged	Staff
2663	EDUC	579	Dir Research/Project	1-2	Arranged	Arranged	6/23-8/15	Arranged	Staff
2665	EDUC	581	Professional Project	2-6	Arranged	Arranged	6/23-8/15	Arranged	Staff
2670	EDUC	590	Thesis	2-8	Arranged	Arranged	6/23-8/15	Arranged	Staff
2675	PSYC	130 †	General Psychology	4	11:00A-12:30P	MTWR	6/23-7/31	SMH305	Egbert
2699	PSYC	215	Child/Adolescent Develop	4	2:00- 4:30P	MTWR	6/30-7/24	RGH205	Ivy
2704	PSYC	501	Statistics in Research	3	5:30- 7:20P	TWR	6/24-7/24	SMH102	Archer
2705	PSYC	502	Statistics Lab	1	7:30- 8:45P	W	6/25-7/30	SMH102	Archer
2720	PSYC	506	Adv Human Development	3	1:00- 2:50P	MTWR	7/7-7/31	SMH305	Melgosa
2736	PSYC	518	Group Counseling	3	8:00A-1:00P	M	6/23-7/28	SMH102	Stough, L
2740	PSYC	521	Psych of Learning	3	10:00-11:50A	TWR	6/24-7/24	SMH102	Archer
2745	PSYC	522	Couns Indiv w/Addictions	3	8:00A-12:00 1:00- 7:00P	M	8/4-8/18	SMH202	Ivy
2751	PSYC	524	Couns Diverse Populations	3	2:00- 7:00P	M	6/23-7/28	SMH102	Archer
2765	PSYC	567	Internship Counsel Psy	2-12	Arranged	Arranged	6/23-8/15	Arranged	Stough, L
2770	PSYC	575	Readings:	2-4	Arranged	Arranged	6/23-8/15	Arranged	Staff
2775	PSYC	581	Professional Project	1-4	Arranged	Arranged	6/23-8/15	Arranged	Staff
2790	PSYC	590	Thesis	2-8	Arranged	Arranged	6/23-8/15	Arranged	Staff
2801	SPED	492	Education of the Gifted	3	8:00- 9:50A	MTWR	6/23-7/17	SMH302	Rittenbach
2825	SPED	535	Reading Diagnosis/Remed	3	Online—see pages 10-11	MTWRF	6/23-8/15	Arranged	Randolph
2850	SPED	550	Understanding Research	3	6:00- 7:50P	MTWR	6/30-7/24	SMH202	Ivy

For other classes of interest to K-12 teachers, look for this symbol ✓ under other department listings:
Art, English, Health & Physical Education, Social Work & Sociology, Theology.

G GenEd Online (general studies) course

† Other general studies course

✓ Course of interest to K-12 teachers

*All summer courses are offered
contingent on adequate enrollment*

ENGINEERING

Call No.	Prefix	Course No.	Course Title	Cr.	Time	Days	Dates	Location	Instructor
3070	ENGR	494	Co-op Educ	0-2	Arranged	Arranged	6/23-8/15	Arranged	Aamodt

ENGLISH

Call No.	Prefix	Course No.	Course Title	Cr.	Time	Days	Dates	Location	Instructor
3305	ENGL	200 †	Tpcs: Engl Lit in Context (Limited enrollment)	4	Arranged	Arranged	6/19-7/25	England	Beem
3333	ENGL	214 G	Themes-Lit: Chld Classics	4	GenEd Online—page 10		6/23-8/15	Arranged	Nosworthy
3370	ENGL	215 †	Intro to Film Lit Lab (Fee: \$15)	4	1:00- 1:50P 1:00- 5:30P	MTWFR	6/23-8/15	ADM117	Wiss
3399	ENGL	360 †	✓ Shakespeare at Ashland (Limit 20)	2	Arranged	MTWRF	8/18-8/22	Ashland	Venden
3405	ENGL	374 ✓	Lit for Children	3	Online—see pages 10-11		6/23-8/15	Arranged	Nosworthy
3430	ENGL	400 †	Tpcs: Lit Engl Reformation (Limited enrollment)	4	Arranged	Arranged	6/19-7/25	England	Beem
3441	ENGL	416 ✓	Teaching With Film Lit Lab (Fee: \$15)	4	1:00- 1:50P 1:00- 5:30P	MTWFR	6/23-8/1	ADM117	Wiss
3445	ENGL	539 ✓	Wksp: Integrat Rdg/Lit/Writ <i>Open to Oregon Conference teachers only.</i>	3	8:30A-12:00 1:00- 4:00P	MTWRF	6/23-7/3	Portland	Cross/Gardner

HEALTH AND PHYSICAL EDUCATION

Call No.	Prefix	Course No.	Course Title	Cr.	Time	Days	Dates	Location	Instructor
4000	HLTH	110 G	✓ Wellness for Living	3	GenEd Online—page 10		6/23-8/15	Arranged	Paulson
4030	HLTH	481	Internship in Hlth Science	12	Arranged	Arranged	6/23-8/15	Arranged	Denney
4055	PEAC	115 †	Wakeboarding/Water Activ (Fee: \$120) (Limit 4)	1	1:00- 9:00P	R	7/24-8/14	WEC118	Windemuth
4090	PEAC	133A †	Aerobic Rhythm	1	8:00- 8:50A	MTWRF	6/23-7/18	WEC GYM	Davis
4101	PEAC	133B †	Aerobic Rhythm	1	8:00- 8:50A	MTWRF	7/21-8/15	WEC GYM	Davis
4199	PETH	473 ✓	Tchg Elem Health/PE	3	8:00- 9:50A	MTWR	6/23-7/17	WEC139	Denney
4210	PETH	490	Internship-Fitness Mgmt	12	Arranged	Arranged	6/23-8/15	Arranged	Denney

HISTORY AND PHILOSOPHY

Call No.	Prefix	Course No.	Course Title	Cr.	Time	Days	Dates	Location	Instructor
4402	HIST	120 †	History of Western Civ	4	8:00- 8:50A	MTWRF	6/23-8/15	ADM117	Gottschall
4410	HIST	200A †	Tpcs: Engl Hist in Context (Limited enrollment)	4	Arranged	Arranged	6/19-7/25	England	Dodds
4425	HIST	200B	Tpcs: U.S. Middle East Pol	3	6:00- 9:00P	SnMTWR	6/22-7/3	ADM117	Fargo
4444	HIST	306 †	Classical Greece & Rome	4	10:00-11:50A	MTWRF	6/23-7/18	ADM238	Gottschall
4470	HIST	394	Directed Reading	1-3	Arranged	Arranged	6/23-8/15	Arranged	Staff
4475	HIST	400A †	Tpcs: Reformation (Limited enrollment)	4	Arranged	Arranged	6/19-7/25	England	Dodds
4499	HIST	400B	Tpcs: U.S. Middle East Pol	3	6:00- 9:00P	SnMTWR	6/22-7/3	ADM117	Fargo
4555	HIST	490	Archaeological Fieldwork	0-4	Arranged	Arranged	6/25-7/30	Jordan	Thomas

MATHEMATICS

Call No.	Prefix	Course No.	Course Title	Cr.	Time	Days	Dates	Location	Instructor
4950	MATH	181 †	Analytic Geom & Calc I	4	11:00-11:50A	MTWRF	6/23-8/15	KRH345	Tiffin
4999	MATH	206 †	Applied Statistics	4	9:00- 9:50A	MTWRF	6/23-8/15	KRH345	Tiffin

G GenEd Online (general studies) course

† Other general studies course

✓ Course of interest to K-12 teachers

*All summer courses are offered
contingent on adequate enrollment*

MODERN LANGUAGES

Call No.	Prefix	Course No.	Course Title	Cr. Time	Days	Dates	Location	Instructor
<i>Elementary French and/or Spanish will be offered, contingent on enrollment.</i>								
5201	FREN	101 †	Elem French	4 8:00-11:50A	MTWR	6/23-7/9	KRH203	Rosas
5202	FREN	102 †	Elem French	4 8:00-11:50A	MTWR	7/10-7/29	KRH203	Rosas
5203	FREN	103 †	Elem French	4 8:00-11:50A	MTWR	7/30-8/14	KRH203	Rosas
5251	SPAN	101 †	Elem Spanish	4 8:00-11:50A	MTWR	6/23-7/9	KRH205	Alfaro
5252	SPAN	102 †	Elem Spanish	4 8:00-11:50A	MTWR	7/10-7/29	KRH205	Alfaro
5253	SPAN	103 †	Elem Spanish	4 8:00-11:50A	MTWR	7/30-8/14	KRH205	Staff

MUSIC

Call No.	Prefix	Course No.	Course Title	Cr. Time	Days	Dates	Location	Instructor
5450	MUHL	124 G	Intro to Music	4 GenEd Online—page 10		6/23-8/15	Arranged	Ritz
5615	MUPF	127B	Brass-Private	1-2 Arranged	Arranged	6/23-8/15	FAC	Beck
5625	MUPF	127O	Organ-Private	1-2 Arranged	Arranged	6/23-8/15	FAC	Scott
5630	MUPF	127P	Piano-Private	1-2 Arranged	Arranged	6/23-8/15	FAC	Richter
5670	MUPF	127V	Voice-Private	1-2 Arranged	Arranged	6/23-8/15	FAC	Janis
<i>(MUPF 217, 227, 237, 317, 427, & 437 are also available in the above applied music lessons.)</i>								
<i>(See Music Department for lesson fees.)</i>								

NURSING

Call No.	Prefix	Course No.	Course Title	Cr. Time	Days	Dates	Location	Instructor
<i>Admission to the School of Nursing as a Nursing major is required before enrolling in the following block of courses.</i>								
OFFERED AT PORTLAND CAMPUS:								
6010	NRSG	210	Intro to Nursing	3 Arranged	Arranged	6/23-8/29	Portland	Wagner
6020	NRSG	211	Fund of Nursing	4 8:30-10:50A	M	6/23-7/25	Portland	Thurnhofer
			Lab (Fee: \$80)	1:00- 3:30P	M			
6030	NRSG	212	Hlth Assess/Nrsg Process	4 8:30-10:50A	M	7/28-8/29	Portland	Tetz
			Lab (Fee: \$80)	1:00- 3:30P	M			
6040	NRSG	213	Pharmacology in Nrsg	4 8:30-10:30A	T	6/23-8/29	Portland	Krull
			Lab (Fee: \$80)	Arranged	TWRF			
6077	NRSG	490	Nursing Practicum	2-4 Arranged	Arranged	6/23-8/29	Portland	Staff
6120	NRSG	494	Co-op Educ	0-4 Arranged	Arranged	6/23-8/29	Portland	Krull

SOCIAL WORK AND SOCIOLOGY

Call No.	Prefix	Course No.	Course Title	Cr. Time	Days	Dates	Location	Instructor
7001	SOWK	464 ✓	Children at Risk	3 9:00A-12:15P	M	6/23-8/11	RGH178	Fleischer
7015	SOWK	490	Field Practicum	2-14 Arranged	Arranged	6/23-8/15	Arranged	McChesney
			Field Practicum Seminar	5:00- 6:00P	T	6/24-8/12	SMH100	McChesney
7020	SOWK	495	Colloquium	0 Arranged	Arranged	6/23-8/15	Arranged	Fleischer
7042	SOWK	508	Soc Work & Religion	2 10:00A-12:30P	T	6/24-8/12	RGH178	Bailey
7045	SOWK	510	Cultur/Ethnic Perspectives	3 2:00- 5:15P	M	6/23-8/11	RGH178	Current
7080	SOWK	530	Field Practicum	2-5 Arranged	Arranged	6/23-8/15	Arranged	McChesney
7090	SOWK	533	Clin Issues-Relationships	3 8:00A-12:00	M	6/23-7/14	KRH346	Vonderfecht
			1:00- 4:00P					
7095	SOWK	541	Advanced Practice	3 6:00- 9:15P	M	6/23-8/11	RGH182	Martin
7101	SOWK	542	Dysfunctional Behavior	3 9:00A-12:15P	M	6/23-8/11	KRH324	Hankins
7150	SOWK	547 ✓	Children at Risk	3 9:00A-12:15P	M	6/23-8/11	RGH178	Fleischer
7167	SOWK	557	Solution-focus Brief Ther	3 8:00A-12:00	M	7/21-8/11	KRH346	Zangar
			1:00- 4:00P					
7177	SOWK	565	Attchmt Theory/Theraplay	2 6:00- 8:15P	M	6/23-8/11	CSP309	Bailey
7182	SOWK	568	Gestalt Therapy	3 2:00- 5:15P	M	6/23-8/11	RGH182	Martin
7188	SOWK	574	Social Work Supervision	3 9:00A-12:15P	M	6/23-8/11	RGH205	Martin
7199	SOWK	575	Clin Prc Crisis Intervention	3 2:00- 5:15P	M	6/23-8/11	KRH324	Hankins

G GenEd Online (general studies) course

† Other general studies course

✓ Course of interest to K-12 teachers

*All summer courses are offered
contingent on adequate enrollment*

SOCIAL WORK AND SOCIOLOGY, continued

Call No.	Prefix	Course No.	Course Title	Cr.	Time	Days	Dates	Location	Instructor
ONLINE/DISTANCE LEARNING COURSES:									
7201	ANTH	225	G Cultural Anthropology	4	GenEd Online—page 10		6/23-8/15	All locations	Ockerman
7205	SOCI	204	G General Sociology	4	GenEd Online—page 10		6/23-8/15	All locations	Current
7209	SOWK	508W1	Soc Work & Religion	2	Online—see pages 10-11		6/23-8/15	CP	Boyd
7227	SOWK	508W2	Soc Work & Religion	2	Online—see pages 10-11		6/23-8/15	Billings	Boyd
7233	SOWK	508W3	Soc Work & Religion	2	Online—see pages 10-11		6/23-8/15	Missoula	Boyd
7255	SOWK	548W	Compar Theories SW Prac	3	Online—see pages 10-11		6/23-8/1	All locations	Vonderfecht
7277	SOWK	549W	Attachment Thru Life Span	3	Online—see pages 10-11		6/23-8/15	Billings/Missoula	Peters
7288	SOWK	563W	Grantsmanship	2	Online—see pages 10-11		6/23-8/15	All locations	Ockerman

OFFERED AT BILLINGS, MONTANA, CAMPUS: *(Also see online courses listed above)*

8010	SOWK	500L	Tpcs: Clin Innov Trt Trauma	3	10:00A-1:15P	M	6/23-8/11	Billings	Barta
8033	SOWK	510L	Cultur/Ethnic Perspectives	3	6:00- 9:15P	M	6/23-8/11	Billings	Kimball-Hilario
8080	SOWK	530L	Field Practicum	2-5	Arranged	Arranged	6/23-8/15	Billings	Kimball-Hilario
8125	SOWK	541L	Advanced Practice	3	10:00A-1:15P	M	6/23-8/11	Billings	Cimmino
8177	SOWK	542L	Dysfunctional Behavior	3	2:00- 5:15P	M	6/23-8/11	Billings	Cimmino
8185	SOWK	557L	Solution-focusd Brief Ther	3	2:00- 5:15P	M	6/23-8/11	Billings	Houston
8188	SOWK	558L	Cognitive/Behavioral Ther	3	10:00A-1:15P	M	6/23-8/11	Billings	Yazak
8199	SOWK	568L	Gestalt Therapy	3	6:00- 9:15P	M	6/23-8/11	Billings	Cimmino

OFFERED AT MISSOULA, MONTANA, CAMPUS: *(Also see online courses listed above)*

9012	SOWK	500M	Tpcs: Trtmt Trauma/Grief	3	2:00- 5:15P	M	6/23-8/11	Missoula	Peters
9033	SOWK	510M1	Cultur/Ethnic Perspectives	3	10:00A-1:15P	M	6/23-8/11	Missoula	Grussling
9044	SOWK	510M2	Cultur/Ethnic Perspectives	3	2:00- 5:15P	M	6/23-8/11	Missoula	Grussling
9050	SOWK	530M	Field Practicum	2-5	Arranged	Arranged	6/23-8/15	Missoula	Emerson
9055	SOWK	544M	Policy Analysis /Advocacy	3	6:00- 9:15P	M	6/23-8/11	Missoula	Grussling
9061	SOWK	556M	Play Therapy	3	10:00A-1:15P	M	6/23-8/11	Missoula	Peters
9175	SOWK	557M	Solution-focus Brief Ther	3	10:00A-1:15P	M	6/23-8/11	Missoula	Szalda-Petree
9180	SOWK	558M	Cognitive/Behavioral Ther	3	6:00- 9:15P	M	6/23-8/11	Missoula	Szalda-Petree
9190	SOWK	573M	Pract/Theor Clin Group Wk	3	2:00- 5:15P	M	6/23-8/11	Missoula	Szalda-Petree

TECHNOLOGY

Call No.	Prefix	Course No.	Course Title	Cr.	Time	Days	Dates	Location	Instructor
7305	AUTO	280	Practicum	1-6	Arranged	Arranged	6/23-8/15	Arranged	Holm
7322	AUTO	480	Adv Practicum	1-6	Arranged	Arranged	6/23-8/15	Arranged	Holm
7370	AVIA	142	Private Pilot Flight Training	3	Arranged	Arranged	6/23-8/29	Flight Ctr	Dietrich/Duffy
7375	AVIA	143	Adv Private Flight Training	3	Arranged	Arranged	6/23-8/29	Flight Ctr	Dietrich/Duffy
7380	AVIA	152	Cross-country Flight	2	Arranged	Arranged	6/23-8/29	Flight Ctr	Dietrich/Duffy
7390	AVIA	262	Instrument Flight Training	3	Arranged	Arranged	6/23-8/29	Flight Ctr	Dietrich/Duffy
7395	AVIA	263	Adv Instrument Flight Trng	3	Arranged	Arranged	6/23-8/29	Flight Ctr	Dietrich/Duffy
7405	AVIA	280	Practicum	1-6	Arranged	Arranged	6/23-8/29	Flight Ctr	Dietrich/Duffy
7410	AVIA	325	Flight Performance	2	Arranged	Arranged	6/23-8/29	Flight Ctr	Dietrich/Duffy
7415	AVIA	335	Commercial Flight Training	3	Arranged	Arranged	6/23-8/29	Flight Ctr	Dietrich/Duffy
7420	AVIA	336	Adv Comm Flight Training	3	Arranged	Arranged	6/23-8/29	Flight Ctr	Dietrich/Duffy
7425	AVIA	340	Multi-engine Flight Training	3	Arranged	Arranged	6/23-8/29	Flight Ctr	Dietrich/Duffy
7428	AVIA	356	Prin of Flight Instruction	3	Arranged	Arranged	6/23-8/29	Flight Ctr	Dietrich/Duffy
7430	AVIA	358	Instructor Flight Training	3	Arranged	Arranged	6/23-8/29	Flight Ctr	Dietrich/Duffy
7440	AVIA	458	Instrument Instruc Flt Trng	3	Arranged	Arranged	6/23-8/29	Flight Ctr	Dietrich/Duffy
7445	AVIA	460	Multi-eng Instrucr Flt Trng	2	Arranged	Arranged	6/23-8/29	Flight Ctr	Dietrich/Duffy
7450	AVIA	480	Adv Practicum	1-6	Arranged	Arranged	6/23-8/29	Flight Ctr	Dietrich/Duffy

Aviation courses may continue into September by individual arrangement.

THEOLOGY

Call No.	Prefix	Course No.	Course Title	Cr.	Time	Days	Dates	Location	Instructor
6551	RELB	104	† Ministry of Jesus	4	9:00- 9:50A	MTWRF	6/23-8/15	ADM117	Veverka
6599	RELB	438	† Matthew–Mark	3	1:00- 2:50P	MTWR	7/21-8/14	ADM116	Veverka
6610	RELB	466	G Galatians & Romans	3	GenEd Online—page 10		6/23-8/15	Arranged	Cosaert
6652	RELH	457	†✓History of Adventism	3	8:00- 9:50A	MTWRF	6/23-7/15	ADM116	Maynard-Reid
6677	RELH	490	Archaeological Fieldwork	0-4	Arranged	Arranged	6/25-7/30	Jordan	Thomas
6710	RELP	494	Co-op Educ	0-3	Arranged	Arranged	6/23-8/15	Arranged	Thomas
6722	RELT	202	G✓Christian Beliefs	4	GenEd Online—page 10		6/23-8/15	Arranged	Cosaert
6727	RELT	417	G✓Inspiration & Revelation	3	GenEd Online—page 10		6/23-8/15	Arranged	Thomas

G GenEd Online (general studies) course

† Other general studies course

✓ Course of interest to K-12 teachers

All summer courses are offered contingent on adequate enrollment

Course Descriptions

(The following course descriptions are for courses offered in the summer of 2008 but not listed in the 2007-08 online University Bulletin or Graduate Bulletin.)

Education and Psychology

EDUC 474 WORKSHOP: LEGO ROBOTICS CURRICULUM INTEGRATION 1-2
Integration of LEGO Robotics into the classroom. Participants will learn methods of teaching robotics, integration with applicable curriculum, and hands-on use of all tools. One credit for workshop; additional credit available for optional project.

EDUC 500 TOPICS: ADVANCED CLASSROOM TECHNOLOGY TOOLS 2
An advanced course in software and hardware commonly used in schools and classrooms. Prerequisite: EDUC 515 or permission of the instructor.

English

ENGL 200 TOPICS: ENGLISH LITERATURE IN CONTEXT 4
The study of English literature from the medieval period to the nineteenth century. Course material will emphasize the role of place and cultural context on the formation of literary works from Beowulf to the Romantic poets. May be substituted for either ENGL 210 or ENGL 211. Offered as part of UK08 Study Tour.

ENGL 400 TOPICS: LITERATURE OF THE ENGLISH REFORMATION 4
A study of the literature reflecting the historical, religious, and literary contexts of the reformation of the church in England. Prerequisite: one course in literature or permission of the instructor. Offered as part of UK08 Study Tour.

ENGL 574 LITERATURE FOR CHILDREN 3
Study of the literature for children from early childhood through elementary school. Emphasizes literary and artistic quality and appeal to children. Requires reading children's books, reading critical theory, and writing critical analysis.

History

HIST 200 TOPICS: ENGLISH HISTORY IN CONTEXT 4
This general studies course will survey English history from 1066 to 1688 within the broad historical themes of the history of Western Civilization. While based in London, Oxford, and York, students will visit a variety of urban and rural sites, including cathedrals, parish churches, castles, palaces, ancient pathways, and mysterious monuments. English and History majors may substitute this course for HIST 274 or HIST 121. Offered as part of UK08 Study Tour.

HIST 200/400 TOPICS: U. S. MIDDLE EAST POLICY 3
This course will explore the rise and development of Islam; its historic interaction with the West; the emergence of the modern Middle East and the factors contributing to conflict and instability in that region; and the challenge of political Islam in the modern world.

HIST 400 TOPICS: REFORMATION 4
An historical study of the religious changes that took place in sixteenth century Europe. While the course will take place as part of the English and History Study Tour in England, the focus will be on the broader reformation. The course will examine the Lutheran Reformation, the Calvinist Reformation, the Anabaptist Reformation, the Catholic Reformation, and the English Reformation. England will provide the perfect laboratory for investigating these religious developments and conflicts from the time of Wycliffe through the English Civil War. Prerequisite: one course in history or permission of the instructor. Offered as part of UK08 Study Tour.

Social Work and Sociology

SOWK 500 TOPICS: CLINICAL INNOVATIONS IN THE TREATMENT OF TRAUMA 3

A study of the clinical efficacy of "non-talk" therapies, such as guided imagery, therapeutic body work, movement therapy, art therapy, and others, in working with traumatized clients. The class will include lecture, guest practitioners, and student presentations. Includes theories about naturalistic and somatic approaches to the resolution and healing of trauma. Students will be invited to participate in experiential learning of the therapies demonstrated throughout the quarter.

SOWK 500 TOPICS: CLINICAL TREATMENT OF TRAUMA, GRIEF, AND ATTACHMENT 3

Exploration of the universal experiences of trauma, grief, and attachment as concurrent clinical themes rather than divergent concepts. Social work students will seek to understand the world of the client within a holistic environment. Theoretical underpinnings will be discussed, as well as best clinical practices.

Technology

PHTO 400 TOPICS: DIGITAL PHOTOGRAPHY 2

Various practices of shooting quality photography with a digital camera. Digital camera selection and use, processing RAW images, editing images for storing and retrieval, using images in different media and doing digital manipulation. Application of the technique of "seeing" the image before capturing it. Making the proper adjustments for composition, lighting, and camera settings to achieve the desired results. (Course fee: \$45.)

Administration

Summer Session Office

Summer Session Director Clinton A. Valley, M.B.A., Ed.D.
Administrative Assistant Beverly Scott, B.A.

Summer Session Committee

Clinton A. Valley, M.B.A., Ed.D., Summer Session Director, Chair
James D. Boyd, M.S.W., Assistant Professor of Social Work
David L. Cowles, Ph.D., Professor of Biology
Marvin L. Denney, M.Ed., Assistant Professor of Health and Physical Education
Julian M. Melgosa, Ph.D., Professor and Dean, School of Education and Psychology

Summer Faculty Committees

Academic Standards Committee Associate Vice President for Academic Administration
Admissions Committee Dallas F. Weis, M.Ed., Chair
Graduate Council Joseph G. Galusha, D.Phil., Chair

Academic Support Services

Academic Advisement **Canaday Technology Center, Room 310**

The Academic Advisement Office assigns each student an adviser; provides information about academic policy, procedures, resources, class placement, and programs; and monitors students' academic progress. The director of Academic Advisement is also available to assist students with changing majors, course selection, and registration for fall quarter.

Career Center **Kretschmar Hall, Room 217**

The services of the Career Center are designed to assist students with career assessment, exploration, and guidance, as well as career-related work experience. Graduating seniors may receive job search coaching, placement file assistance, and information on graduate and professional school programs.

Disability Support Services **Village Hall, Lower Level**

In accordance with Section 504 of the Rehabilitation Act of 1973 and the Americans With Disabilities Act of 1990, Disability Support Services provides access to students with either permanent or temporary disabilities through a variety of services and equipment. Students requesting accommodations need to provide appropriate documentation of a disability. The Disability Support Services Office is located in the Teaching Learning Center in the lower level of Village Hall; phone 527-2366 or 527-2313.

Teaching Learning Center **Village Hall, Lower Level**

Special, free, drop-in tutorial help is available in the Teaching Learning Center for all students who wish to improve their basic skills or increase their understanding of content in lower-division classes. Trained upper-division students tutor individuals or small groups. Established tutorial services are available in mathematics, sciences, writing, and other subjects. The Writing Center is open to all students, including graduate students, who wish to learn how to improve or polish their papers.

University Administration

John K. McVay, Ph.D., President
Ginger Ketting-Weller, Ph.D., Vice President for Academic Administration
Steven G. Rose, B.S.B.A., Vice President for Financial Administration
Ken Rogers, M.A., Vice President for Student Life
Rosa Jimenez, B.A., Interim Vice President for University Advancement
Dallas F. Weis, M.Ed., Interim Vice President for Enrollment
Pedrito U. Maynard-Reid, Th.D., Vice President for Spiritual Life and Mission
Clinton A. Valley, M.B.A., Ed.D., Associate Vice President for Academic Administration
James R. Hall, M.B.A., Associate Vice President for Financial Administration
Joseph G. Galusha, D.Phil., Associate Vice President for Graduate Studies

Administrative Staff

Academic Administration

Dean, School of Business, Clarence G. Anderson, Ph.D.
Dean, School of Education and Psychology, Julian M. Melgosa, Ph.D.
Dean, School of Engineering, Larry D. Aamodt, Ph.D.
Dean, School of Nursing, Lucille Benson Krull, Ph.D.
Associate Dean, School of Nursing, Trudy L. Klein, M.S.
Dean, School of Social Work and Sociology, Pamela Keele Cress, Ph.D.
Dean, School of Theology, David E. Thomas, D. Min.
Chair, Department of Art, Thomas J. Emmerson, M.F.A.
Chair, Department of Biological Sciences, Scott H. Ligman, Ph.D.
Chair, Department of Chemistry, Steven H. Lee, Ph.D.
Chair, Department of Communications, Nancy L. Semotiuk, M.A.
Chair, Department of Computer Science, Anthony A. Aaby, Ph.D.
Chair, Department of English, Nancy K. Cross, M.A.
Chair, Department of Health and Physical Education, Marvin L. Denney, M.Ed.
Summer Chair, Department of History and Philosophy, Terrell D. Gottschall, Ph.D.
Chair, Department of Mathematics, Kenneth L. Wiggins, Ph.D.
Chair, Department of Modern Languages, Jean-Paul Grimaud, Maitrise en Français
Chair, Department of Music, Matthew H. James, D.M.A.
Chair, Department of Physics, Thomas B. Ekkens, Ph.D.
Chair, Department of Technology, Linda F. Nelson, Ed.D.
Director, University Libraries, Carolyn S. Gaskell, M.A.

Academic Support

Registrar, Carolyn Denney, B.S.
Director of Academic Advisement, Betty Duncan, B.A.
Director of Admissions, Dallas F. Weis, M.Ed.
Director of Career Center, Nelle Cornelison, M.Ed., M.S.
Director of Rosario Beach Marine Laboratory, James R. Nestler, Ph.D.
Director of Recruitment, Don Veverka, B.A.
Director of Summer Session, Clinton A. Valley, M.B.A., Ed.D.
Director of Teaching Learning Center and Disability Services, Kristy Guldhammer, M.A.
Director of Technical Support Services, James Forsyth, M.A.
Manager, KGTS Station, Kevin Krueger, B.A.

University Advancement

Director, Alumni Relations, Ed Ammon, B.A.
Director, Capital Campaigns, Dorita Tessier, B.S.
Director, University Relations, Rosa Jimenez, B.A.
Director, Estate Planning Services, Allan Fisher, Ed.D.

Financial Administration

Director of Human Resources, Shane Voshell, B.B.A.

Director of Student Financial Services, Cassie Ragenovich, B.S.

Executive Director of Physical Plant Operations and Information Services, Jerry Mason, B.S.

Manager, University Shop, Barbara Bigger, M.A.

Student Services

Dean of Men, John Foote, B.S.

Dean of Women, Bunny R. A. Reed, B.S.

Director of Counseling and Testing Center, Donald E. Wallace, Ph.D.

Director of Campus Health and Wellness, Patrick R. Smart, R.N., M.S.N., A.R.N.P.

Director of Village Student Life, Padraic McCoy, B.A.

General Manager, Campus Dining Services, Miles R. Rottman, B.A.

Residence Hall Dean (Portland Campus), Eileen Stuart, R.N., M.S.W., A.C.S.W.

Summer Session Faculty

Aaby, Anthony A., Ph.D., Professor of Computer Science

Aamodt, Larry D., Ph.D., Professor of Engineering

Ahrens, Shannon, M.A., Guest Lecturer in Education

Alfaro, Alma, Ph.D., Assistant Professor of Modern Languages

Anderson, Clarence G., Ph.D., Professor of Management

Archer, Austin C., Ph.D., Professor of Education and Psychology

Bailey, Cindee M., Ph.D., Professor of Social Work and Sociology

Banks, John, Ph.D., Guest Lecturer in Biology

Barta, Peggy, M.S.W., Adjunct Faculty in Social Work

Beck, W. Brandon, M.Mus.Ed., Associate Professor of Music

Beem, Beverly G., Ph.D., Professor of English

Boyd, James D., M.S.W., Assistant Professor of Social Work

Cimmino, Paul F., Ph.D., Visiting Professor of Social Work

Clark, Douglas R., Ph.D., Guest Lecturer in History and Religion

Cosaert, Carl P., Ph.D., Assistant Professor of Theology

Cowles, David L., Ph.D., Professor of Biology

Creitz, Randall, M.A.T., Guest Lecturer in Education

Cress, Pamela Keele, Ph.D., Professor of Social Work and Sociology

Cross, Jeff, M.S., Visiting Assistant Professor of Chemistry

Cross, Nancy K., M.A., Associate Professor of English

Current, Cheris Brewer, Ph.D., Assistant Professor of Social Work and Sociology

Davis, Linnae, B.S., Guest Lecturer in Physical Education

Denney, Marvin L., M.Ed., Assistant Professor of Health and Physical Education

Dietrich, Shawn E., B.A., B.S., Instructor in Technology

Dodds, Gregory Dean, Ph.D., Associate Professor of History

Duffy, Loury J., B.S., Instructor in Technology

Egbert, Robert D., Ph.D., Professor of Education and Psychology

Ekkens, Thomas B., Ph.D., Assistant Professor of Physics

Emerson, Karen, M.S.W., Visiting Assistant Professor of Social Work

Emmerson, Thomas J., M.F.A., Professor of Art

Fargo, Mumtaz, Ph.D., Guest Lecturer in History

Fitch, Robert S., M.A., Guest Lecturer in Biology

Fleischer, Douglas B., M.S.W., Associate Professor of Social Work and Sociology

Galusha, Joseph G., D.Phil., Professor of Biology

Gardner, Susan, Ph.D., Guest Lecturer in English

Gottschall, Terrell D., Ph.D., Professor of History

Grimaud, Jean-Paul, Maîtrise en Français, Associate Professor of Modern Languages

Grussling, Kevin D., M.S.W., Assistant Professor of Social Work and Sociology

Hankins, Randi, M.S.W., Visiting Assistant Professor of Social Work
 Holm, Robert D., M.S., Instructor in Technology
 Houston, Natasha, M.S.W., Adjunct Faculty in Social Work
 Ivy, Linda L., Ph.D., Assistant Professor of Psychology
 James, Matthew H., D.M.A., Professor of Music
 Janis, Christine, D.M.A., Guest Lecturer in Music
 Ketting-Weller, Ginger, Ph.D., Professor of Education
 Kimball-Hilario, Harriett, M.S.W., Visiting Assistant Professor of Social Work
 Klein, Trudy L., M.S., Assistant Professor of Nursing
 Krull, Lucille Benson, Ph.D., Professor of Nursing
 Lee, Steven H., Ph.D., Professor of Chemistry
 Ligman, Scott H., Ph.D., Professor of Biology
 Martin, Lana B., Ph.D., Professor of Social Work
 Maynard-Reid, Pedrito U., Th.D., Professor of Biblical Studies and Missiology
 McChesney, Marja, Ph.D., Professor of Social Work and Sociology
 Melgosa, Julian M., Ph.D., Professor of Education and Psychology
 Merklin, Marshall L., Ed.S., Guest Lecturer in Education
 Motzev, Mihail, Ph.D., Professor of Business
 Nelson, Linda F., Ed.D., Professor of Technology
 Nestler, James R., Ph.D., Professor of Biology
 Nosworthy, Sylvia B., Ph.D., Professor of English
 Ockerman, Janet Dee, Ph.D., Professor of Social Work and Sociology and Guest Lecturer in Education
 Paulson, Bob, M.A., Guest Lecturer in Health and Physical Education
 Peters, Nancy R., Ph.D., Associate Professor of Social Work
 Randolph, Tamara L., Ph.D., Associate Professor of Education
 Richter, Leonard, Ph.D., Professor of Music
 Rittenbach, Gail S., Ph.D., Professor of Education and Psychology
 Ritz, Lyn C., D.M.A., Associate Professor of Music
 Robinson, Frances J., B.S., Guest Lecturer in Education
 Rosas, Luisa, M.A., Guest Lecturer in Modern Languages
 Scott, Craig S. M., D.M.A., Professor of Music
 Scott, Martin, B.S., Guest Lecturer in Computer Science
 Semotiuk, Nancy L., M.A., Associate Professor of Communications
 Silva, Deborah, Ph.D., Assistant Professor of Communications
 Stough, R. Lee, Ph.D., Professor of Psychology
 Stough, Susan, Ph.D., Guest Lecturer in Education
 Szalda-Petree, Ann C., Ph.D., Visiting Associate Professor of Social Work
 Taylor, John Wesley, Ph.D., Guest Lecturer in Education
 Tetz, Karen B., Ph.D., Professor of Nursing
 Thomas, David E., D.Min., Professor of Theology
 Thompson, Dana G., Ed.D., Professor of Finance and Economics
 Thurnhofer, Janice R., M.N., Guest Lecturer in Nursing
 Tiffin, Timothy L., D.A., Professor of Mathematics
 Toews, Bruce J., M.B.A., Associate Professor of Business
 Venden, LuAnn R., Ph.D., Associate Professor of English
 Veverka, Larry E., M.A., Associate Professor of Pastoral Care
 Vonderfecht, Heather R., Ph.D., Visiting Associate Professor of Social Work
 Wagner, Lynn R., M.S., Associate Professor of Nursing
 Weller, James C., M.Ed., Guest Lecturer in Education
 Wells, Keith, M.Ed., Guest Lecturer in Education
 Wiggins, JoAnn Y., Ph.D., Professor of Business
 Wiggins, Kenneth L., Ph.D., Professor of Mathematics
 Windemuth, Timothy M., M.A., Associate Professor of Health and Physical Education
 Wiss, Gary Alan, D.A., Professor of English
 Woodland, Dennis, Ph.D., Guest Lecturer in Biology
 Yazak, Daniel L., D.Ed., Visiting Professor of Social Work
 Zangar, Sheila, M.S.W., Adjunct Faculty in Social Work

Notes

Schedule Planner						
	Monday	Tuesday	Wednesday	Thursday	Friday	Credits
7:00						
8:00						
9:00						
10:00						
11:00						
12:00						
1:00						
2:00						
3:00						
4:00						
5:00						
6:00						
Total credits:						

Campus Buildings

Map Locations

1. Plant Services
2. Winter Educational Complex
3. Old Rogers School Site
4. Canaday Technology Center
5. Office of Enrollment
6. Risk and Safety Management
7. The Express
8. University Church
9. Kretschmar Hall
10. Havstad Alumni Center
11. Chan Shun Pavilion
12. Bowers Hall
13. Campus Security
14. Spiritual Life and Mission
15. Melvin K. West Fine Arts Center
16. Powerhouse
17. Sittner Hall

18. Centennial Green
19. University Shop
20. Village Hall
21. Foreman Hall
22. Conard Hall
23. Meske Hall
24. Peterson Memorial Library
25. Rigby Hall
26. Smith Hall
27. Kellogg Hall
28. Mountain View Apartments
29. Social Work/Sociology
30. University Studios and Guest Rooms
31. University Village Life
32. Hallmark Apartments
33. Birch Street Apartments
34. Administration Building

- | | |
|-------|---|
| ADM | Administration Building (English, History, Theology) |
| AGYM | Alumni Gymnasium, located in WEC |
| ALBRM | Havstad Alumni Center Boardroom |
| BWH | Bowers Hall |
| CSP | Chan Shun Pavilion (Engineering) |
| CTC | Canaday Technology Center (Communications, Technology) |
| FAC | Melvin K. West Fine Arts Center (Art, Music) |
| KRH | Kretschmar Hall (Computer Science, Mathematics, Modern Languages, Physics) |
| LIB | Peterson Memorial Library |
| NRS | Portland Campus Nursing Building |
| POOL | Tausick Memorial Pool, located in WEC |
| RGH | Rigby Hall (Biology, Chemistry) |
| SMH | Smith Hall (Education & Psychology) |
| SWK | Social Work/Sociology Complex |
| TLC | Teaching Learning Center, located in Village Hall |
| VLH | Village Hall |
| WEC | Winter Educational Complex (Business, Health & Physical Education, Nursing) |

Schedule Abbreviations

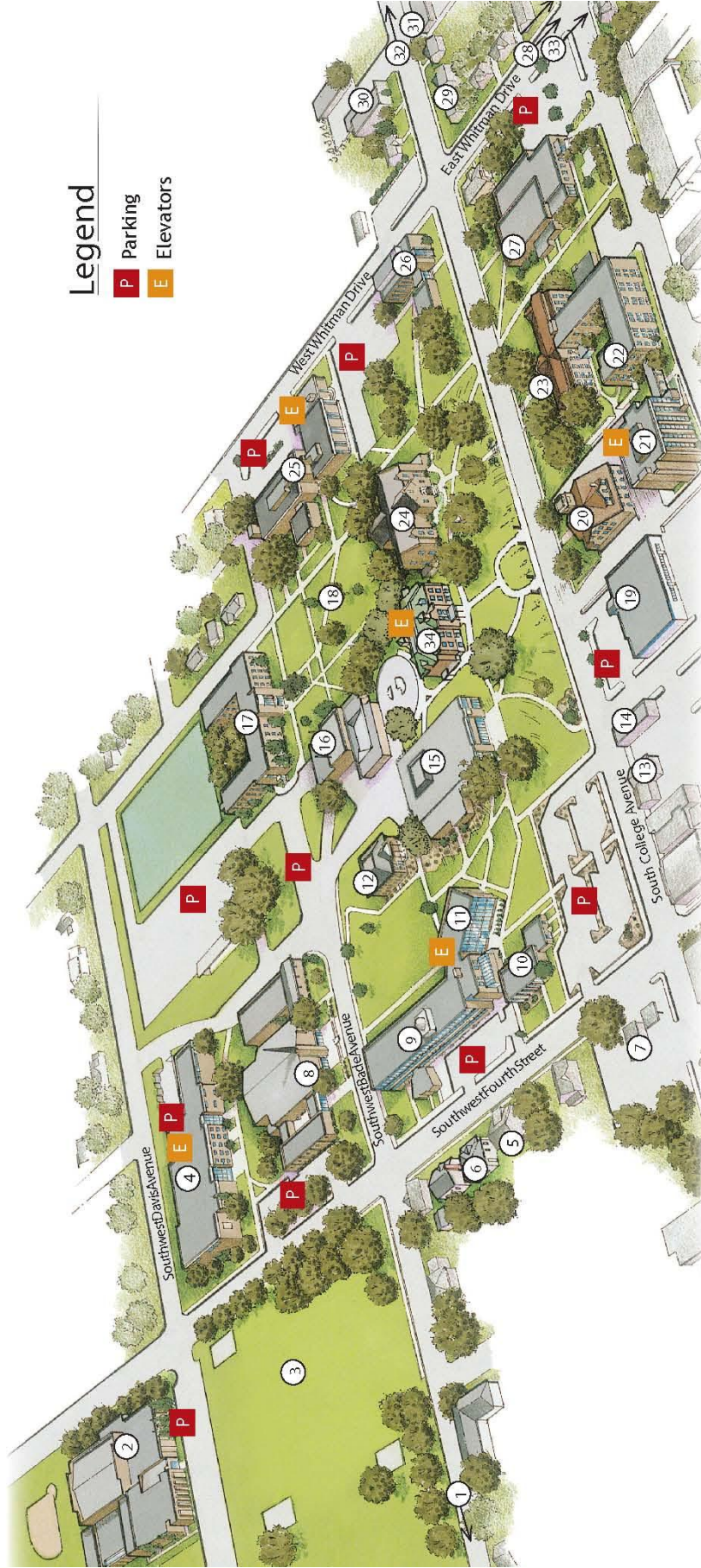

Legend

- P Parking
- E Elevators